

FAG

609

Deep groove ball bearing

Schaeffler ID:
0383907100000Deep groove ball bearing 60, single row,
steel sheet metal cage

Technical information

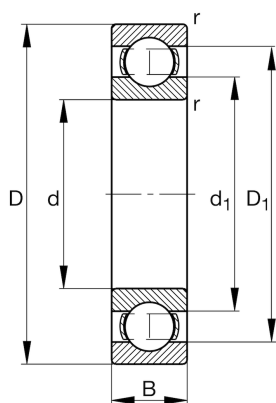

Main Dimensions & Performance Data

d	9 mm	Bore diameter
D	24 mm	Outside diameter
B	7 mm	Width
C_r	3,350 N	Basic dynamic load rating, radial
C_{0r}	1,430 N	Basic static load rating, radial
C_{ur}	43 N	Fatigue load limit, radial
n_G	38,000 1/min	Limiting speed
n_{gr}	28,500 1/min	Reference speed
	15 g	Weight

Dimensions

r_{min}	0.3 mm	Minimum chamfer dimension
D_1	19.46 mm	Shoulder diameter outer ring
d_1	13.85 mm	Shoulder diameter inner ring

Mounting dimensions

$d_{a min}$	11 mm	Minimum diameter shaft shoulder
$D_{a max}$	22 mm	Maximum diameter of housing shoulder
$r_{a max}$	0.3 mm	Maximum fillet radius

Calculation factors

f_0	13	Calculation factor
-------	----	--------------------

Temperature range

T_{min}	-30 °C	Operating temperature min.
T_{max}	120 °C	Operating temperature max.